

Superior 700



Superior 700 is Gram Professional's top-of-the-range series, combining market-leading energy efficiency with high cooling capacity and operational reliability and long service life. With an annual energy consumption of only 278 kWh, the cabinet delivers best-in-class performance without compromise.

The cabinet features a 2/1 GN depth, allowing space for two 1/1 GN containers in depth, positioned on wire shelves or directly on support rails with anti-tilt function.

The chiller operates within a temperature range of -5 to +12 °C, while the freezer covers -25 to -5 °C, ensuring high flexibility for professional kitchen applications.

The cabinet is equipped with an intuitive and intelligent controller for optimal operation and low energy consumption, as well as an ergonomic design with full-length handle, self-closing door, rounded corners and removable magnetic door gaskets for optimal hygiene.

Delivered in the well-known high quality from Gram Professional, ensuring stable operation and long service life.

Standard equipment:

- Stainless steel interior and exterior
- 4 stainless steel wire shelves
- Reversible right-hinged door with self-closing function and lock
- Efficient LED lighting
- Practical pedal door opener
- Legs can be adjusted in height 135/200 mm

Optional:

- Additional wire shelves and support rails
- Perforated shelves
- Left-hinged door
- Castor set

	CHILLER -5/+12°C	FREEZER -25/-5°C
PRODUCT NAME	SUPERIOR C700 G S R L2 4S	SUPERIOR F700 G S R L2 4S
ITEM NUMBER	947011001	947021001
VOLUME (liter, gross/net)	610 / 454	610 / 454
NUMBER OF SHELVES	4	4
ENERGY EFFICIENCY CLASS / EEI	A / 20,5	C / 38,8
ENERGY CONSUMPTION (kWh/year)	278	1439
SOUND LEVEL (dB (A))	46,4	46,7
COOLING CAPACITY AT -10°C (W)	425	-
COOLING CAPACITY AT -25°C (W)	-	553
CLIMATE CLASS	5 (40°C/40% RH)	5 (40°C/40% RH)
DIMENSIONS W x D x H (mm)	700x895x2125	700x895x2125
GROSS WEIGHT (kg)	131	132
REFRIGERANT / CHARGE	R290 / 0,078 kg	R290 / 0,058 kg
GWP / Co2 EQUIVALENT	3 / 0,000234 t	3 / 0,000234 t
CONNECTION	230 V, 50 Hz / 1,1 A	230 V, 50 Hz / 1,7 A
CONNECTION LOAD (W)	198	375

C700 / F700

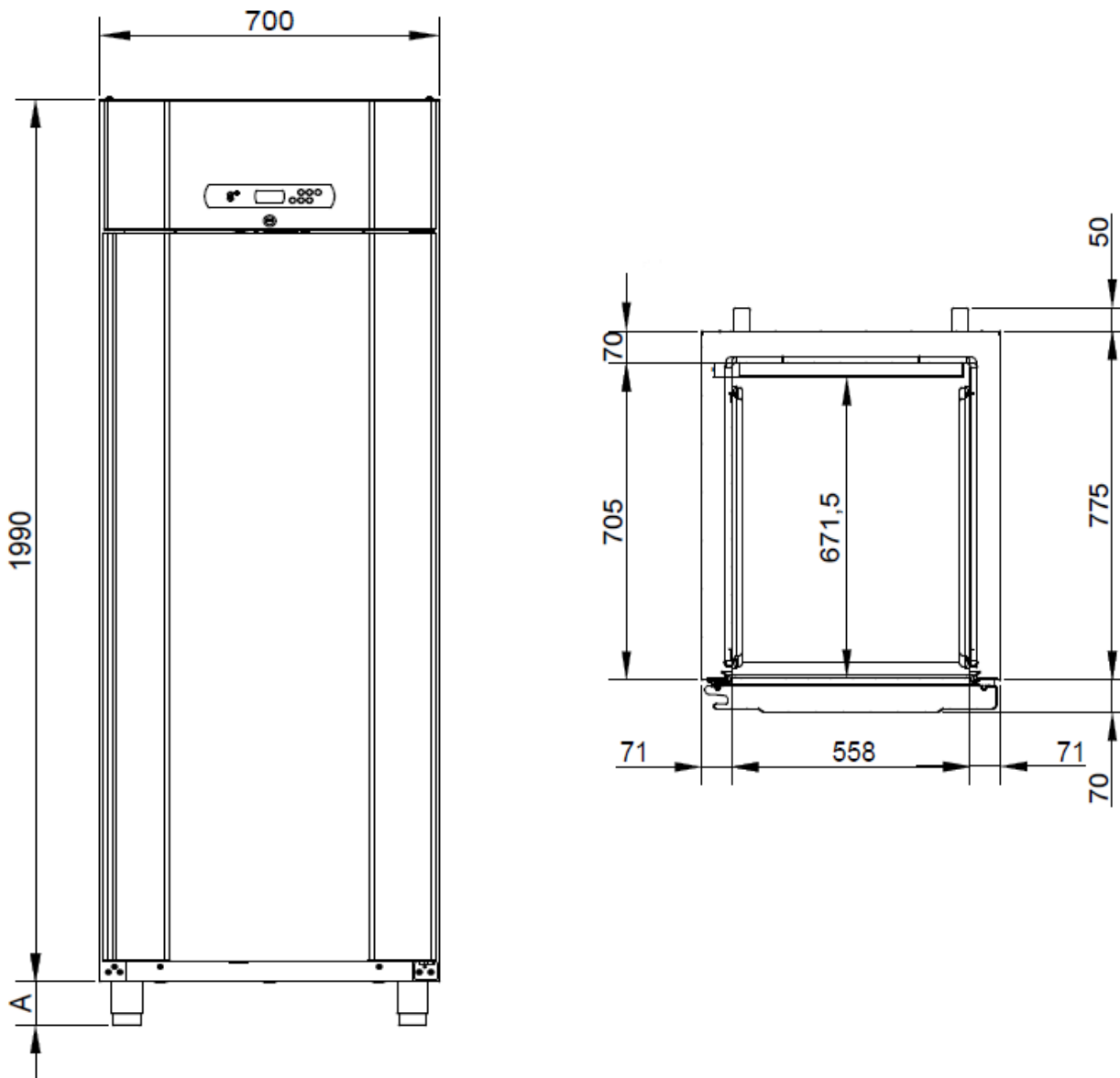

A: Legs can be adjusted to a height of 135/200 mm