

ECO 700



ECO 700 with capacity for two 1/1 GN containers in depth, which can be placed on the cabinet's wire shelves or directly on the support rails.

The chiller features an extended temperature range from -5 to +12°C, providing greater flexibility and supporting the kitchen's changing needs for storing a wide variety of ingredients. The freezer has a temperature range from -25 to -5°C.

Innovative and user-friendly controls ensure optimal operation and low energy consumption. Ergonomic design with a full-length door handle and a self-closing door, rounded corners and removable magnetic door gaskets ensure optimal hygiene.

Standard equipment:

- Stainless steel interior and exterior
- 3 grey wire shelves
- Reversible right-hinged door with self-closing function and lock
- Efficient LED lighting
- Legs can be adjusted in height 135/200 mm

Optional:

- Additional wire shelves and support rails
- Stainless steel wire shelves or perforated shelves
- Left-hinged door
- Castor set

	CHILLER -5/+12°C	FREEZER -25/-5°C
PRODUCT NAME	ECO C700 G S R L2 3N	ECO F700 G S R L2 3N
ITEM NUMBER	946911001	946921001
VOLUME (liter, gross/net)	610 / 454	610 / 454
NUMBER OF SHELVES	3	3
ENERGY EFFICIENCY CLASS / EEI	A / 23,8	C / 41,4
ENERGY CONSUMPTION (kWh/year)	322	1535
SOUND LEVEL (dB (A))	46,4	46,7
COOLING CAPACITY AT -10°C (W)	425	-
COOLING CAPACITY AT -25°C (W)	-	502
CLIMATE CLASS	5 (40°C/40% RH)	5 (40°C/40% RH)
DIMENSIONS W x D x H (mm)	700x895x2125	700x895x2125
GROSS WEIGHT (kg)	131	132
REFRIGERANT / CHARGE	R290 / 0,078 kg	R290 / 0,058 kg
GWP / Co2 EQUIVALENT	3 / 0,000234 t	3 / 0,000174 t
CONNECTION	230 V, 50 Hz / 1,1 A	230 V, 50 Hz / 2,18 A
CONNECTION LOAD (W)	198	382

C700 / F700

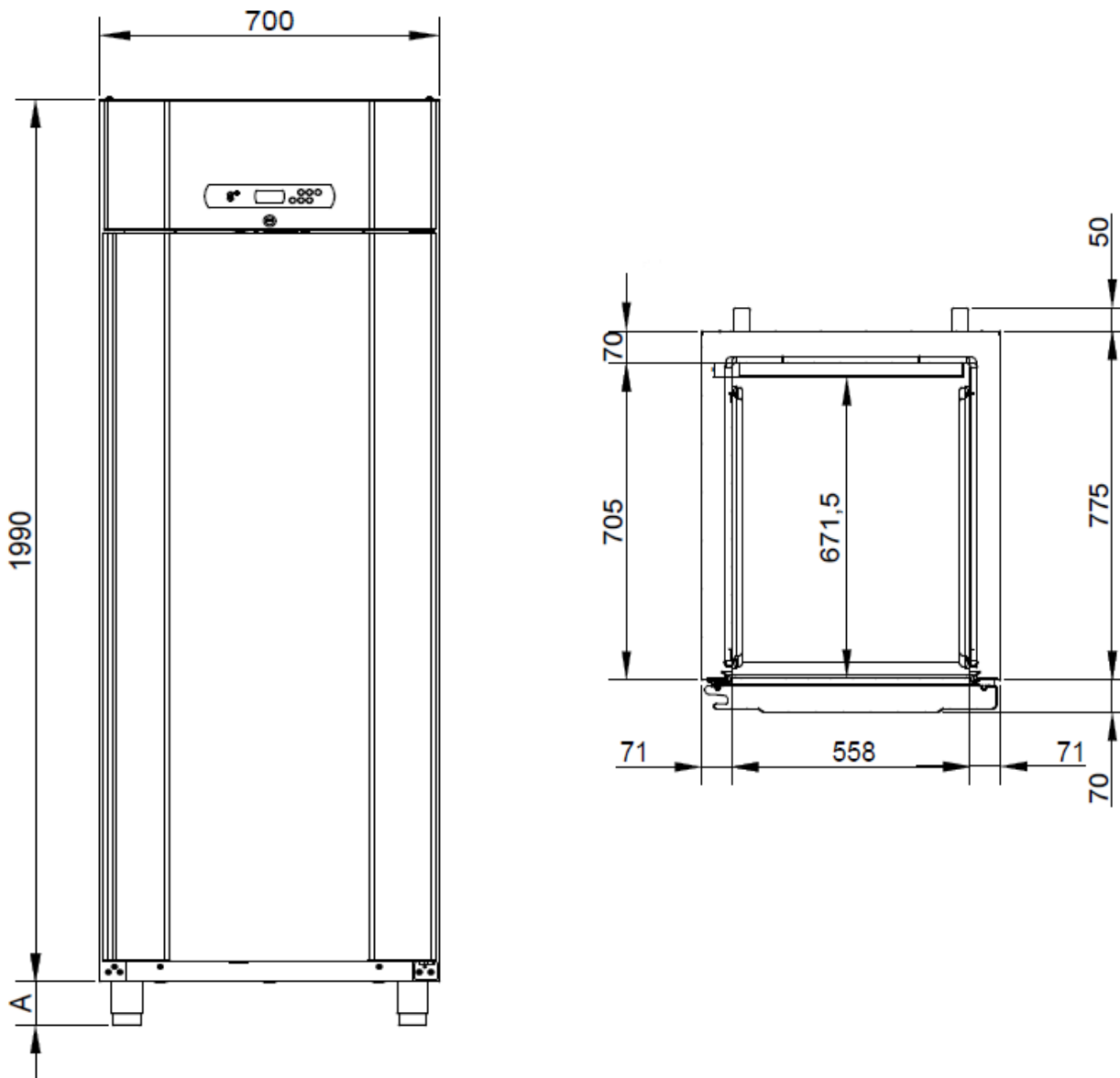

A: Legs can be adjusted to a height of 135/200 mm